

## FEATURES

Arm will swing out when hit directly by vehicle to avoid further damage on the vehicle.

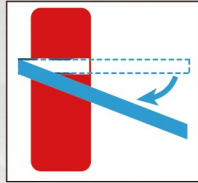

The Hall Effect Sensor is adopted which has high reset accuracy, simple structure, broad frequency response, long service life, and good applicability to severe weather conditions. (Compare to the traditional limit switch).

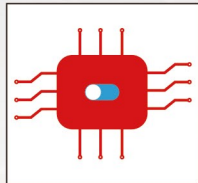

In the event of power failure, just open the cabinet and manually control the barrier by a gear mechanism. Also barrier boom can be manually locked in any position between horizontal and vertical, the lock status will remain until unlock manually.

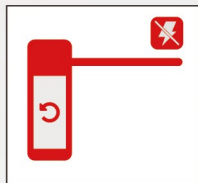

Using one of the best powder (Brand: Akzonobel), makes every colors is **GREEN** Compliance of AAMA-2603. Protection against UV, Corrosions, and Color Fading\*

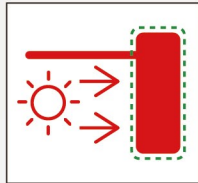

The pressure wave, infrared column, loop detector and other access control can be added to improve safety.



## Model:HBG-409E

Optional Arm Type	Open/Close Speed	Max Length
Anti-Collision Arm	3s	4m
Ellipse Straight Arm	3s/6s	4m/5m
Ellipse Connect Arm	3s	4m
Articulated Arm	3s/6s	3.5m/5m
Ellipse Straight Arm (with LED Strip)	3s/6s	4m/5m

# TECHNICAL SPECIFICATION

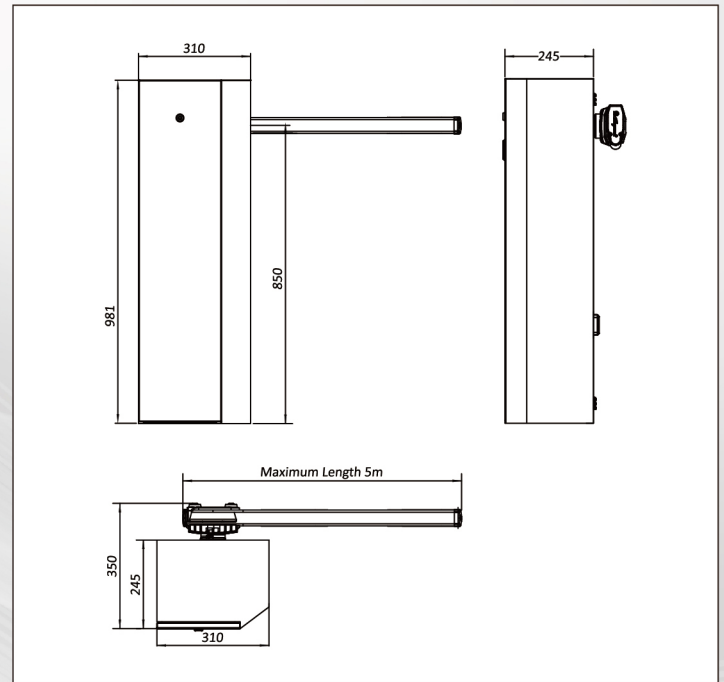
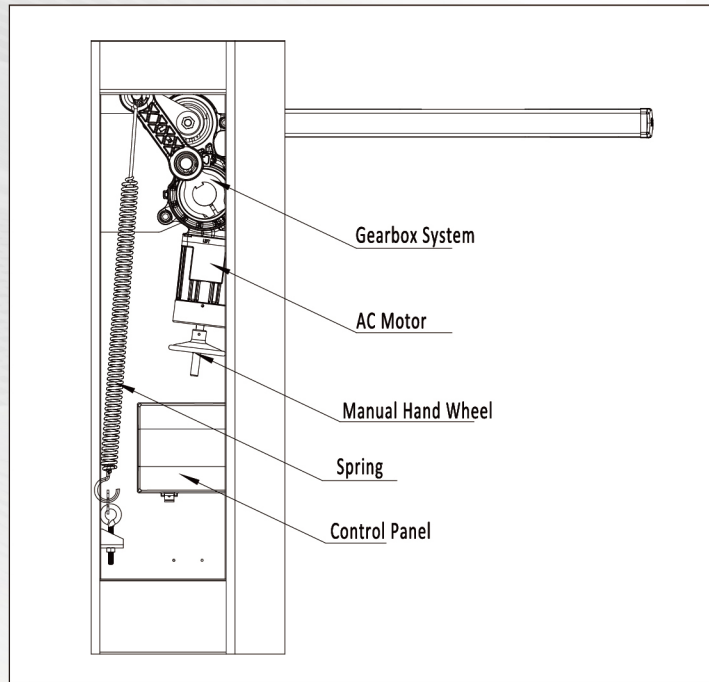

## Electrical Specification

Input Voltage	220V $\pm$ 10%, 50Hz-60Hz
Motor Power	100W
Motor RPM	1300r/min
Operation Temperature	-30°C ~ +50°C
IP Rating	IP44
Insulation Grade	E
Weight (kg)	32Kg
Length Limit (m)	5.0
Open& Close Speed	3.0s, 6.0s



Infrared Device

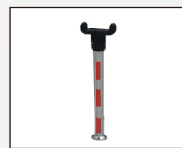

Supporting Pole

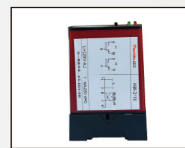

Loop Detector



433MHz Remote Control

## HONGMEN ADVANCED TECHNOLOGY CORPORATION

Headquarter:

Hongmen Technology Park,

Jihua road, Buji, Shenzhen, Guangdong province, CHINA.

Postal code 518129

Tel : +86 755 89584581

E-mail : [info@hongmenglobal.com](mailto:info@hongmenglobal.com)

Website : [www.hongmenglobal.com](http://www.hongmenglobal.com)

